



## Features

- **2.1Mega-Pixel 1/3" Panasonic CMOS sensor**
- **Full HD resolution 1920X1080p/30fps**
- **114units IR LED**
- **f3.5-16mm Mega pixel Vari-focal lens**
- **True Day&Night with ICR mechanism**
- **External lens control / Built in joystick for OSD control**
- **D-WDR, SENS-UP, 3D DNR, SMART IR function**
- **Suspended type cable concealed bracket**

## Visual Performance

### Ultra resolution (Full HD)



Conventional

Full HD

We provide you Full HD-SDI for color and B/W. User can expect extremely clear and excellent visual image quality.

### LED Performance / IR Distance

Max. 50m (114 IR LED) 0m



## Dimensions (Unit : mm)

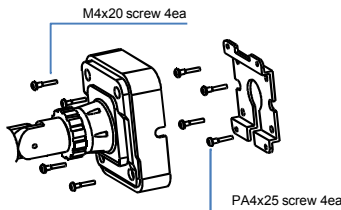
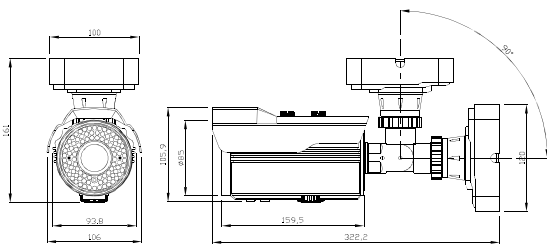

Suspended type bracket assembly

## 3D Exploded Diagram

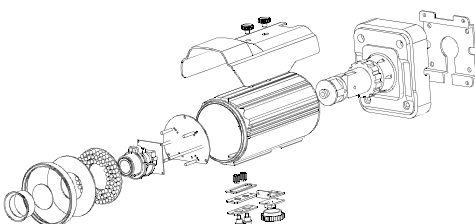

## Specification

Model	KIR-114HVF
Image Device	1/3" Panasonic CMOS
Scanning System	Progressive Scan
Total Pixels	2010(H) x 1108(V)
Effective pixel	1944(H) x 1092(V)
Electronic Shutter	60Hz: 1/30~1/30,000sec, 50Hz: 1/25~1/30,000sec
Digital Resolution	1920x1080p (1080p/25,30fps)
Video Output	HD-SDI / CVBS (NTSC, PAL)
SDI FORMAT	1080P
Resolution & Frame rate	1080@30p/25p
Min. Illumination	0 Lux (IR LED On) / 0.1 Lux@F1.2 / 30IRE
Lens	f3.5-16mm Mega pixel vari-focal lens
Day&Night	True Day&Night with ICR filter mechanism
LED	114units IR LED / 850nm
On Screen Display	Built in Joystick controller
Language	ENG/JPN/CHN1/CHN2
Brightness	0~100
AGC	0~16
Shutter Mode	AUTO/MANUAL
Shutter Speed	1/30(25), 60(50), FLK, 250, 500, 1K, 2K, 5K, 10K, 50K
Sens-Up	OFF/x2/x3/x4/x6/x8/x10/x15/x20/x30/x60
White Balance	ATW/AWC/INDOOR/OUTDOOR/MANUAL
D-WDR	High/Middle/Low/Off
Back Light	HSBLC/BLC/OFF
3D DNR	ON/OFF
Smart IR	ON/OFF, LEVEL : 0~100
D-EFFECT	ON(Freeze/Mirror/D-Zoom/NEG. Image)/OFF
Motion	ON(Select/Display/Sensitivity/Motion view/Default)/OFF
Privacy	ON(Select/Display/Color/Default)/OFF
Operation Temperature	-10°C~+50°C
Power Consumption	DC12V ±10%, Max. 1.2A
Dimension	106(W)x106(H)x322(D)mm
Weight	Approx. 1.0Kg